



2045		2043	
\$421,800		\$384,800	
2	BEDS	2	BEDS
2	BATHS	2	BATHS
3	GARAGE	2	GARAGE
1330	SQ FT	1210	SQ FT
FEATURED UPGRADES		FEATURED UPGRADES	
Den		Tiled Master Shower	
Quartz/Onyx Countertops		Vinyl Plank Hallway & Living Rm	
Tiled Master Shower		Composite Deck	
Vinyl Plank Hallway & Living Rm		Garage Insulated & Firetaped	
Oversized Covered Deck		Garage Hot & Cold Spigot	
Oversized Garage		Yard	
Garage Insulated & Finished through texture & paint		HOA	
Yard and HOA			

Built by:
Nielson
CONSTRUCTION

Westview Estates in Sioux Falls offers high-end twin homes units with sleek finishes and spacious living areas, perfect for entertaining. HOA living at its best. The open floor plan includes a corner walk-in pantry, island, living room boasting great natural light, dining room with sliders to a covered composite deck. A tiled walk-in shower and an impressive walk-in closet complement the primary suite. The unfinished lower level provides future potential for two additional bedrooms, a full bathroom, and spacious family room area.

LISTED BY **HOUSE 2 HOME, LLC**

AMY

605.400.3784

amy@nielsonconstruction.net

AMANDA

605.254.6044

amanda.treloar@nielsonconstruction.net



MORE LISTINGS AT

BuiltByNielson.com

Information deemed reliable but not guaranteed. Images are for marketing purposes only.

version03182026

FLOOR *plan* >>>

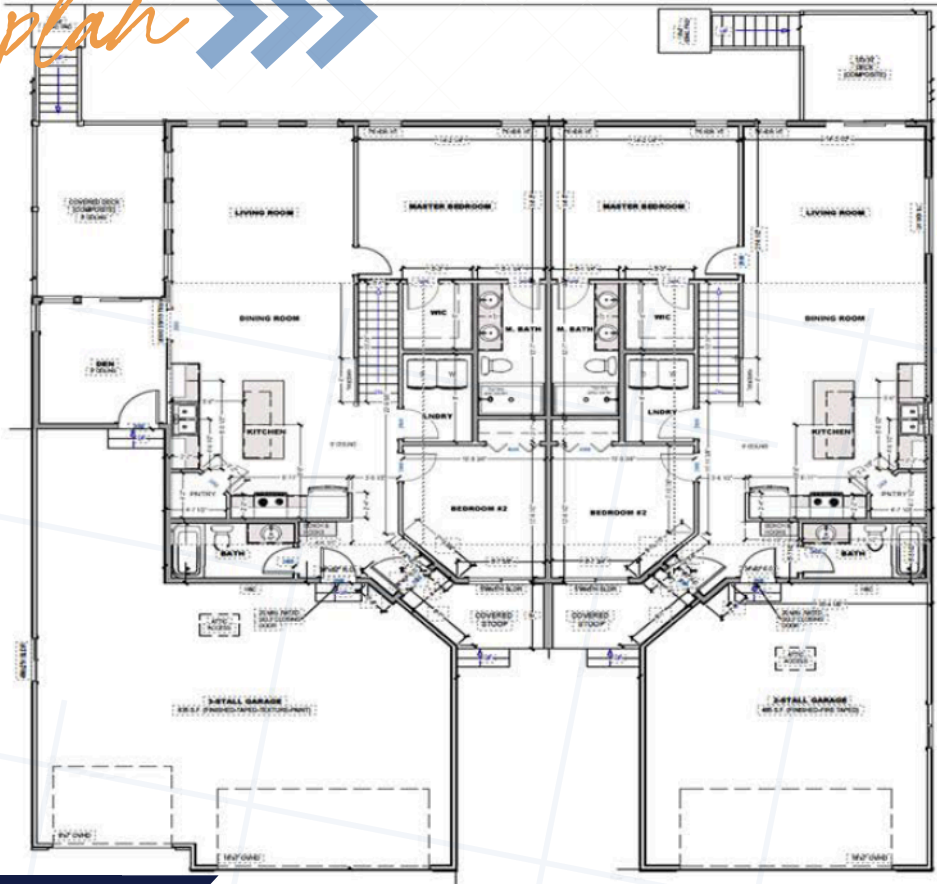

SIMILAR TO IMAGES

Natural Stain



Built by:
Nielson
CONSTRUCTION

This floor plan including furniture, measurements and dimensions are approximate and for illustration only. BoxBrownie.com gives no guarantee, warranty or representation as to the accuracy and layout. All inquires must be directed to the agent, vendor or party representing this floor plan.